

Pneumatics

Hose/Regulators/Fittings.....	13-3
Hose Reels.....	13-13

Hose/Regulators/Fittings

Air Hose

Warranty: Six Months

231-0039 Air Hose Assembly

- Constructed with a yellow, oil and abrasion resistant outer cover, extra strong polyester braiding, inner tube, rugged bend restrictor, and solid brass fittings
- Maximum working pressure: 2400 kPa (350 psi)
- Made of virgin resin PVC giving it excellent flexibility and low temperature resistance
- Easy-to-handle, lightweight hose reduces operator fatigue
- Each package contains 15 meters (50 ft) of 9.6 mm (0.38 in) ID hose
- 1/4 inch male NPT threaded brass fitting on each end



Part Number	Description
231-0039	Air Hose Assembly

Air Hose Assembly Coiled

Warranty: Manufacturer's

- Designed for service only
- Ideal air hose for blow guns, nut setters, etc
- Constructed of lightweight fungus-resistant, oil-and water-impervious nylon
- Spring-wound hose extends over 20 times its stored length with permanent memory
- 360° swivel couplings at both ends



Maximum burst pressure	4960.8 kPa (720 psi)
Maximum working pressure	1240.2 kPa (180 psi)
Operating temperature range	6.67° to 76.67° C (20° to 170° F)

Part Number	Length	Hose I.D.	Male NPT Each End
1U-7714	3.66 m (12 ft)	9.525 mm (0.375 in)	9.525 mm (3/8 in)
1U-7715	7.62 m (25 ft)	9.525 mm (0.375 in)	9.525 mm (3/8 in)
1U-7716	15.24 m (50 ft)	9.525 mm (0.375 in)	9.525 mm (3/8 in)

Part Number	Length	Hose I.D.	Male NPT Each End
4C-4506	3.66 m (12 ft)	6.35 mm (0.25 in)	6.35 mm (1/4 in)
4C-4507	7.62 m (25 ft)	6.35 mm (0.25 in)	6.35 mm (1/4 in)
4C-4508	3.66 m (12 ft)	12.7 mm (0.5 in)	12.7 mm (1/2 in)
4C-4509	7.62 m (25 ft)	12.7 mm (0.5 in)	12.7 mm (1/2 in)
4C-4510	15.24 m (50 ft)	12.7 mm (0.5 in)	12.7 mm (1/2 in)

Extra Heavy-Duty Quick-Detach Air Couplers and Connectors

Warranty: Six Months

Part Number	Description	NPTF Size	Pressure Drop @100 psi	Air Volume
Standard Type				
1U-7717	Connector	1/4 in (f)	10 psi (68.9 kPa)	30 cfm
1U-7721	Quick Disconnect Coupler	1/4 in (m)	10 psi (68.9 kPa)	30 cfm
Volume Type				
1U-7718	Coupler	1/2 in (f)	20.67 kPa (3 psi)	80 cfm
1U-7719	Coupler	3/4 in (f)	20.67 kPa (3 psi)	80 cfm
1U-7720	Connector	1/2 in (m)	20.67 kPa (3 psi)	80 cfm
1U-7722	Connector	3/4 in (m)	20.67 kPa (3 psi)	80 cfm

4C-8854 Filter Regulator Lubricator Kit

Warranty: Six Months

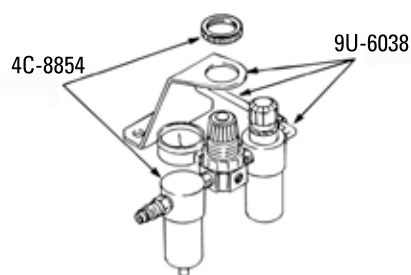

- Requires 9U-6038 Mounting Kit if mounted directly on the pump

Max. inlet pressure	21 bar (300 psi)
Regulated range	0 - 12.4 bar (0 - 180 psi)
Inlet and outlet	1/4 in NPT(f)
Gauge port (gauge included)	1/8 in
Capacity for filter and lubricator	1 oz and 20 micron

Part Number	Description	Overall Width	Overall Height	Overall Depth
4C-8854	Filter Regulator Hose and Fitting Kit	130 mm (5.1 in)	130 mm (5.1 in)	40 mm (1.6 in)

9U-6038 Filter Regulator Mounting Kit

Warranty: Six Months

- Includes mounting Bracket, two 90° air fittings, air line

Part Number	Description
9U-6038	Filter Regulator Mounting Kit

Hose and Fitting Kits

Warranty: Six Months

4C-7362 72-inch Hose and Fitting Kit for 5:1 Fire-Ball

- For use with drum mounted 5:1 Fire-Ball pumps
- Use 4C-7046 3/8 inch Air Regulator as required (not included, sold separately)

4C-7364 72-inch Hose and Fitting Kit for 10:1 President

- For use with drum mounted 10:1 President pumps
- Use 4C-7033 1/2 inch Air Regulator as required (not included, sold separately)

Included	
307-883	Instruction Form

(Continued)

Hose and Fitting Kits (Continued)

Warranty: Six Months

Part Number	Description	Size
4C-7362	Hose and Fitting Kit	--
4C-7364	Hose and Fitting Kit	--
4C-7362 Consist		
4C-7102	Union	3/8 in
4C-7334	Hose 3000	1/2 in
4C-7101	Union	1/2 in
4C-7364 Consist		
4C-7221	Hose 180	1/2 x 72 in
4C-7101	Union	1/2 in
4C-7047	Hose 2250	3/4 in
4C-7145	Union	3/4 in

Air Supply Accessories

Air Filters

Warranty: Six Months

- Centrifugal action and 40 micron element remove water and foreign particles from plant air supply
- Maximum working pressure: 13 bar (180 psi)



Part Number	Description	Air Inlet	Working Pressure	Bowl Capacity	Filter Micron	Maximum scfm
4C-8851	Filter	1/4 in NPT(f)	21 bar (300 psi)	30 ml (1 fl oz)	20	22
4C-7041	Filter	3/8 in NPT(f)	17.5 bar (250 psi)	150 ml (5 fl oz)	20	77
4C-7042	Filter	1/2 NPT(f)	17.5 bar (250 psi)	240 ml (8 fl oz)	20	106
4C-7043	Filter	3/4 in NPT(f)	17.5 bar (250 psi)	480 ml (16 fl oz)	40	250

Air Regulators

- Precision control of outlet air pressure
- Feedback principle allows constant pressure to pump regardless of air demand rate and fluctuations in supply pressure
- Maximum working pressure: 21 bar (300 psi)



(Continued)

Air Regulators (Continued)

Part Number	Description	Air Inlet	Maximum scfm	Pressure Range
4C-8852	Regulator	1/4 in NPT	15	0 - 12.4 bar (0 - 180 psi)
4C-7046	Regulator	3/8 in NPT(f) with gauge	90	0 - 17.24 bar (0 - 250 psi)
4C-7033	Regulator	1/2 in NPT(f)	90	0 - 17.24 bar (0 - 250 psi)
4C-7248	Regulator	3/4 in NPT(f)	380	0 - 8.62 bar (0 - 125 psi)

Air Lubricator

Warranty: Six Months



- Extends life of pump and smooths pump movement by applying measured lubricant to all moving parts within the pump air motor
- Control knob and sight window allow adjustment of lubricant dispensed
- Maximum working pressure: 13 bar (180 psi)

Part No.	Description	Air Inlet	Max. scfm	Max. Pressure	Bowl Capacity
4C-8853	Lubricator	1/4 in NPT(f)	12	21 bar (300 psi)	30 ml (1 fl oz)
4C-7266	Lubricator	3/8 in NPT(f)	88	17.5 bar (250 psi)	150 ml (5 fl oz)
4C-7267	Lubricator	1/2 in NPT(f)	127	17.5 bar (250 psi)	240 ml (8 fl oz)
4C-7268	Lubricator	3/4 in NPT(f)	290	17.5 bar (250 psi)	480 ml (16 fl oz)

Air Supply Combination Units

Warranty: Six Months



- Easy-to-install combination units include filter, regulator, pressure gauge, lubricator, and connection fittings
- Complete, convenient
- Maximum working pressure: 13 bar (180 psi)

Part Number	Description	Air Inlet	Working Pressure
4C-7272	Lubricator	1/2 in NPT(f)	17.5 bar (250 psi)
4C-8854	Lubricator	1/4 in NPT(f)	21 bar (300 psi)
4C-7273	Lubricator	3/4 in NPT(f)	17.5 bar (250 psi)
4C-8855	Lubricator	3/8 in NPT(f)	17.5 bar (250 psi)
Filter Regulator Mounting Kit (for all the above)			
9U-6038	Filter Regulator Mounting Kit for all of the above	--	--

Shutoff Valve

Warranty: Six Months

- Closes air inlet to pump and relieves trapped air pressure
- Recommended for each pump drop line
- Maximum working pressure: 13 bar (180 psi)

Part Number	Description	Air Inlet
4C-7090	Valve	1/4 in NPT(f)
4C-7091	Valve	3/8 in NPT(f)
4C-7093	Valve	3/4 in NPT(f)



Quick-Connect Nipple

Warranty: Six Months

- Easy attachment to air motor inlet
- Male fitting allows threading directly into air motors
- Maximum working pressure: 13 bar (180 psi)

Part Number	Description	Size
4C-7156	Quick Disconnect Nipple, 1/4 NPT Female	1/4 in (f)
4C-7158	Fitting	1/4 in (m)
4C-7159	Fitting	3/8 in (m)
4C-8856	Fitting	1/2 in (m)
4C-8857	Fitting	3/4 in (m)



Quick-Connect Coupler

Warranty: Six Months

- Fast, convenient air hose attachment
- Female thread allows easy attachment to air hoses
- Maximum working pressure: 13 bar (180 psi)

Part Number	Description	Size
4C-7253	Coupling	1/4 in NPT(f)
4C-8858	Coupler	3/8 in NPT(f)
4C-8859	Coupling	1/2 in NPT(f)
4C-8860	Coupling	3/4 in NPT(f)

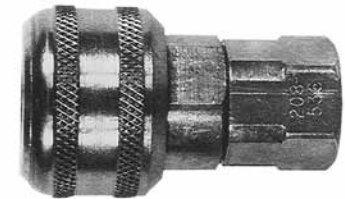

Air Disconnect Coupler

4C-9017 Air Pressure Gauge

- Allows visual check of air pressure being supplied to pump
- Rated to 14 bar (200 psi)
- Includes 1/4 inch NPT(m) ports

Part Number	Description
4C-9017	Air Pressure Gauge



Manifolds - Air Supply Line

Warranty: Six Months



- Supply several pumps from a common air supply line
- Air inlet port is larger than delivery ports to ensure adequate air flow to all pumps
- Maximum working pressure: 13 bar (180 psi)

Part No.	Description	Size with Two Inlet Ports	Size with Four Outlet Ports
4C-7138	Manifold	1/2 in NPT(f)	3/8 in NPT(f)

4C-9018 Tire Chuck



- Durable, full volume tool for maintaining, adding or relieving air pressure
- Maximum working pressure: 13 bar (180 psi)

Part Number	Description
4C-9018	Tire Chuck

4C-8953 Tire Chuck

Warranty: Six Months

- Tire chuck with Quick-Disconnect coupler-nipple
- Use on air reel
- Maximum working pressure: 13 bar (180 psi)

Part Number	Description
4C-8953	Tire Chuck

Pneumatics

Lockout Valves

Essential Tool

Warranty: Six Months



- Used to prevent air flow to a tool or equipment (lock out)
- When yellow plastic slide is open, air flow is unrestricted
- When slide is closed, air supply is shut off and a padlock can be used to prevent accidental opening of air valve
- Fits 1/2 and 3/4 inch NPT pipe

Part No.	Inlet and Outlet Ports	Size (L x W x H)	Maximum Inlet Pressure	Max. Temperature	Padlock Hole Diameter
239-5429	1/2 in female NPT	54 x 38 x 58 mm (2.1 x 1.5 x 2.3 in)	17 bar (250 psig)	150° F (65° C)	7.62 mm (0.30 in)
239-5430	3/4 in female NPT	70 x 35 x 63 mm (2.8 x 1.4 x 2.5 in)	17 bar (250 psig)	150° F (65° C)	7.62 mm (0.30 in)

Air/Water Hose

Warranty: Six Months

- Fabric reinforced general-purpose hose
- Use with air or water, antifreeze, and windshield wash
- Color: red

9.52 mm (3/8 in) ID - 12.6 bar (180 psi) also Includes:		
Part Number	Length	Fittings
4C-7058 (second size, first size in table below)	9.144 m (30 ft)	9.52 mm (3/8 in) M x 12.7 mm (1/2 in) M
19.05 mm (3/4 in) ID - 12.6 bar (180 psi) also Includes:		
4C-7083 (second size, first size in table below)	121.92 cm (48 in)	19.05 mm (3/4 in) M x 19.05 mm (3/4 in) M
4C-7083 (third size, first size in table below)	182.88 cm (72 in)	19.05 mm (3/4 in) M x 19.05 mm (3/4 in) M

Part Number	Length	Fittings
6.35 mm (1/4 in) ID - 12.6 bar (180 psi)		
4C-7050	121.92 cm (48 in)	6.35 mm (1/4 in) M x 6.35 mm (1/4 in) M
4C-7053	7.62 m (25 ft)	6.35 mm (1/4 in) M x 12.7 mm (1/2 in) M
4C-7054	12.192 m (40 ft)	6.35 mm (1/4 in) M x 12.7 mm (1/2 in) M
9.52 mm (3/8 in) ID - 12.6 bar (180 psi)		
4C-7055	15 in	9.52 mm (3/8 in) M x 12.7 mm (1/2 in) M
4C-7056	121.92 cm (48 in)	9.52 mm (3/8 in) M x 9.52 mm (3/8 in) M
4C-7057	3.048 m (10 ft)	9.52 mm (3/8 in) M x 9.52 mm (3/8 in) M
4C-7058	7.62 m (25 ft)	9.52 mm (3/8 in) M x 12.7 mm (1/2 in) M
4C-7060	12.192 m (40 ft)	9.52 mm (3/8 in) M x 12.7 mm (1/2 in) M

Part Number	Length	Fittings
9.52 mm (3/8 in) ID - 12.6 bar (180 psi) (Continued)		
4C-7061	18.288 m (60 ft)	9.52 mm (3/8 in) M x 12.7 mm (1/2 in) M
4C-7208	45.72 cm (18 in)	9.52 mm (3/8 in) M x 9.52 mm (3/8 in) M
12.7 mm (1/2 in) ID - 12.6 bar (180 psi)		
4C-7221	--	1/2 in
4C-7254	12.192 m (40 ft)	12.7 mm (1/2 in) M x 12.7 mm (1/2 in) M
19.05 mm (3/4 in) ID - 12.6 bar (180 psi)		
4C-7083	45.72 cm (18 in)	19.05 mm (3/4 in) M x 19.05 mm (3/4 in) M
4C-7256	7.62 m (25 ft)	19.05 mm (3/4 in) M x 19.05 mm (3/4 in) M
4C-7269	3.048 m (10 ft)	19.05 mm (3/4 in) M x 19.05 mm (3/4 in) M

Pneumatics

Pipe Fittings — 345 bar (5000 psi)

NPT Bushing — Reducing, Standard, and Reducing

Warranty: Six Months



Part Number	Description	Thread Size, Male x Female
4C-7136	NPT Bushing	1 in x 3/4 in
4C-7005	NPT Bushing	1/2 in x 1/4 in
4C-7154	NPT Bushing	1/2 in x 3/4 in

Part Number	Description	Thread Size, Male x Female
4C-7003	NPT Bushing	1/2 in x 3/8 in
4C-7143	NPT Bushing	1/4 in x 1/2 in
4C-7000	NPT Bushing	1/4 in x 1/8 in

(Continued)

Pipe Fittings — 345 bar (5000 psi) (Continued) NPT Bushing — Reducing, Standard, and Reducing

Warranty: Six Months

Part Number	Description	Thread Size, Male x Female
4C-7098	NPT Bushing	1/4 in x 3/8 in
4C-7142	NPT Bushing	1/8 in x 1/4 in
4C-7096	NPT Bushing	1/8 in x 1/8 in
4C-7116	NPT Bushing	1/8 in x 3/8 in
4C-7020	NPT Bushing	3/4 in x 1/2 in
4C-7010	NPT Bushing	3/4 in x 1/4 in

Part Number	Description	Thread Size, Male x Female
4C-7009	NPT Bushing	3/4 in x 3/8 in
3B-7722	Bushing-Pipe-Reducing 3/8 in-18 NPTF to 1/4 in-18 NPTF	3/8 in x 1/4 in
4C-7097	NPT Bushing	3/8 in x 3/8 in
4C-7111	NPT Bushing	3/8 in x 1/2 in

Street Elbow - Pipe Fittings

Warranty: Six Months



Part Number	Description	Thread Size, Male x Female
4C-7016	Street Elbow	1/4 in x 1/4 in
4C-7109	Street Elbow	3/8 in x 3/8 in
4C-7161	Street Elbow	3/4 in x 3/4 in
8T-6756	Street Elbow	1/2 in x 1/2 in

NPT Coupling — Standard

Warranty: Six Months



Part Number	Description	Thread Size
4C-7007	NPT Coupling	1/8 in
4C-7169	NPT Coupling	1/4 in
4C-7150	NPT Coupling	3/8 in
4C-7135	NPT Coupling	1/2 in
4C-7006	NPT Coupling	3/4 in
4C-7008	NPT Coupling	1 in

NPT Hex Nipple — Standard and Reducing

Warranty: Six Months



Part Number	Description	Thread Size, Male x Female
4C-7134	NPT Hex Nipple	1 in x 3/4 in
4C-7133	NPT Hex Nipple	1/2 in x 1/2 in
4C-7151	NPT Hex Nipple	1/2 in x 1/4 in
4C-7140	NPT Hex Nipple	1/2 in x 3/8 in
4C-7121	NPT Hex Nipple	1/4 in x 1/4 in
4C-7099	Hex Nipple, 1/4 x 1/8 NPT	1/4 in x 1/8 in
4C-7122	NPT Hex Nipple	3/4 in x 1/2 in
4C-7160	NPT Hex Nipple	3/4 in x 3/4 in
4C-7153	NPT Hex Nipple	3/8 in x 1/4 in
4C-7115	NPT Hex Nipple	3/8 in x 1/8 in
4C-7120	NPT Hex Nipple	3/8 in x 3/8 in

NPT Square-Head Plug

Warranty: Six Months

Part Number	Description	Thread Size
4C-7011	NPT Square-Head Plug	1/2 in
4C-7032	NPT Square-Head Plug	1/4 in
4C-7039	NPT Square-Head Plug	3/4 in
4C-7001	NPT Square-Head Plug	3/8 in



Pipe Swivels — 345 bar (5000 psi)

Warranty: Six Months

NPT Swivel Adapter — Male x Female — Straight

Warranty: Six Months

Part Number	Description	Rigid Thread x Swivel Thread
4C-7252	NPT Swivel Adapter	1/8 in x 1/4 in
4C-7125	NPT Swivel Adapter	1/4 in x 3/8 in
4C-7107	NPT Swivel Adapter	3/8 in x 3/8 in
4C-7152	NPT Swivel Adapter	3/8 in x 1/2 in
4C-7175	NPT Swivel Adapter	1 in x 3/4 in
4C-7144	NPT Swivel Adapter	1 in x 1 in
4C-7129	NPT Swivel Adapter	3/4 in x 3/4 in



NPT Swivel Adapter — Female x Female — 90°

Warranty: Six Months

Part Number	Description	Rigid Thread x Swivel Thread
4C-7108	NPT Swivel Adapter	3/8 in x 3/8 in
4C-7141	NPT Swivel Adapter	3/8 in x 1/2 in
4C-7123	NPT Swivel Adapter	1/2 in x 1/2 in
4C-7124	NPT Swivel Adapter	1/4 in x 1/4 in
4C-7117	NPT Swivel Adapter	3/4 in x 3/4 in



NPT Swivel Adapter — Female x Female — Straight

Warranty: Six Months

Part Number	Description	Rigid Thread x Swivel Thread
4C-7105	NPT Swivel Adapter	1/4 in x 1/4 in
4C-7106	NPT Swivel Adapter	1/2 in x 1/4 in
4C-7112	NPT Swivel Adapter	3/4 in x 3/4 in
4C-7113	NPT Swivel Adapter	3/8 in x 3/8 in
4C-7139	NPT Swivel Adapter	3/8 in x 1/4 in
4C-7148	NPT Swivel Adapter	1/2 in x 3/8 in



NPT Swivel Adapter — Male x Female — 90°

Warranty: Six Months



Part Number	Description	Rigid Thread x Swivel Thread
4C-7101	Union	1/2 in x 1/2 in
4C-7104	NPT Swivel Adapter	1/4 in x 1/4 in
4C-7103	NPT Swivel Adapter	3/8 in x 1/4 in
4C-7102	Union	3/8 in x 3/8 in

NPT Swivel Adapter — Male x Female — 45°

Warranty: Six Months



Part Number	Description	Rigid Thread x Swivel Thread
4C-7149	NPT Swivel Adapter	3/8 in x 3/8 in
4C-7040	NPT Swivel Adapter	3/4 in x 3/4 in

416-0313 Lock Ring Tool

Model Usage: 785, 789, 793, 795, 797

Warranty: Six Months



- Used with the Topy Quick change rim where lock rings have drilled and tapped holes at each end to safely remove tension in lock rings
- Tool bolts adjust outward to slowly release tension in lock rings
- Used during installation process adjusts inward to apply tension to lock ring
- Used to safely remove tension in lock rings and to safely install lock rings during tire assembly

Specifications			
Part Number	Description	Dimensions	Weight
416-0313	Lock Ring Tool	386 x 105 x 70 mm (15.2 x 4.1 x 2.8 in)	3.9 kg (8.5)

Hose Reels

Open Reels

Warranty: Manufacturer's

- 500 Series is an extreme duty reel for very heavy-duty installations such as mining, construction or bus/truck fleets
- Heavy construction features such as double pedestal arms and double roller arms provide the industry's most rigid reel support, eliminating the need for external bracing
- The larger, heavier design provides for a reel capacity of 60 ft of 3/8 inch air/water hose, 18.28 m (50 ft) of 12.7 mm (1/2 in) oil dispense hose, or 18.28 m (50 ft) of 9.5 mm (3/8 in) high pressure grease hose



Open Dispense Reels

Service	Part Number	Hose Size	Valve Number
Grease			
Grease, 276 bar (4000 psi)	4C-7277	9.5 mm x 12.19 m (3/8 in x 40 ft)	None ¹
Grease, 345 bar (5000 psi)	4C-7278	6.35 mm x 15.24 m (1/4 in x 50 ft)	None
Oils			
Motor Oil, A.T.F., Gear Lube Hydraulic Fluids 126 bar (1800 psi)	4C-7285	12.7 mm x 15.24 m (1/2 in x 50 ft)	None ¹
Replacement Hose	4C-7354	12.7 mm x 15.24 m (1/2 in x 50 ft)	--
Air/Water			
Air/Water, 12.6 bar (180 psi)	4C-7295	9.5 mm x 18.28 m (3/8 in x 60 ft)	None

¹Select correct grease valve

Mounting Bracket

There's no drilling or welding required to hang 500 series reels. Predrilled and threaded brackets allow bolt-together assembly. It's as easy as 1-2-3.

1. Attach channel-mounting bracket (1) to "I" beam. Bolts and clamps included with bracket
2. Bolt 1 to 6 reel-mounting channels (2) to mounting brackets; Channel is pre-threaded
3. Then just bolt the reels to the mounting channel - "Keyhole" slots eliminate lifting of reels while trying to engage a bolt, a definite plus when working on ladders or scaffolding

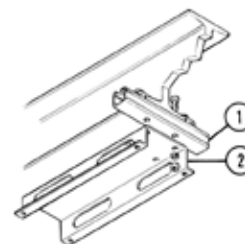

4C-7321 Reel Mounting Channel

- For mounting of from one to three open reels in a bank
- Channel is predrilled to allow individual mounting of reels
- For reel banks over three, use multiple channels

Part Number	Description
4C-7321	Reel Mounting Channel

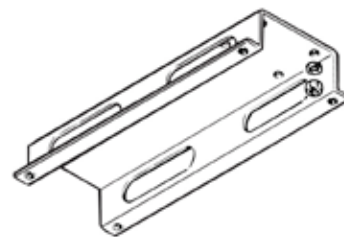

Hose Reels

Accessories

4C-7304 Medium Pressure Inlet Hose Kit



- Inlet hose and fittings rated for 138 bar (2000 psi)

Part Number	Description	Size
4C-7304	Medium Pressure Inlet Hose Kit	12.7 x 609.6 mm (1/2 x 24 in)

4C-7305 High Pressure Inlet Hose Kit

- Inlet hose and fittings rated for 276 bar (4000 psi)
- Inlet hose must be ordered separately for 500 series reels

Part Number	Description	Size
4C-7305	High Pressure Inlet Hose Kit	9.5 x 609.6 mm (3/8 x 24 in)

4C-7044 Fluid Shut-Off Valve



Part Number	Description	Size
4C-7044	Fluid Ball Valve	12.7 mm (1/2 in)

4C-7174 Grease Dispense Line Shut-Off Valve



- 1/2 inch NPT(f) ported valve for drop-line isolation
- Needle valve construction rated for 345 bar (5000 psi)

Part Number	Description
4C-7174	Grease Dispense Line Shut-Off Valve

Service Label Kits - Reels



Service Label Kits 19.05 x 107.95 mm (3/4 x 4 1/4 in) metal labels and mounting hardware	
Part Number	Description
4C-7311	Motor Oil
4C-7312	Grease
4C-7313	Gear Lube
4C-7314	ATF
4C-7315	Hydraulic Oil
4C-7316	Air
4C-7317	Water
4C-7318	Anti-Freeze

(Continued)

Service Label Kits - Reels (Continued)

Service Label Kits 19.05 x 107.95 mm (3/4 x 4 1/4 in) metal labels and mounting hardware	
Part Number	Description
4C-7319	Evacuation

4C-7034 Hanger Kit

Warranty: Six Months

Part Number	Description
4C-7034	Hanger Kit

- Mounts to side of hose reel for hanging oil grease dispense valves

Hose Reels

Warranty: Six Months

European Union compliant, CE marked

- Compact hose reels can be used for air tools, fleet maintenance facilities, wash-down bays, service trucks, utility trucks, agricultural, industrial, mining, and many other applications
- Compact reel holds more hose and has greater reliability than conventional reels
- Weighs up to 35% less than conventional reels of the same size
- Base and guide arms are designed to prevent metal flexing and nearly eliminate guide arm bending when hose is pulled laterally
- Guide arm assembly is easily adjustable for floor, wall, ceiling, pit, or truck mounting positions
- Full-flow ball bearing swivel provides maximum working pressure with minimum spring retraction resistance
- Main shaft support assembly includes permanently lubricated and sealed ball bearings for smooth, long lasting, and trouble-free performance
- Unitized design eliminates possibility of seal leakage while providing precise alignment and structural integrity
- Drive springs are made from scaleless, blue-tempered spring steel for long life and durability
- ISO 9001 approved

Overall size	609.6 x 266.7 x 644.7 mm (24.00 x 10.50 x 25.38 in)
Inlet	1/2 in or 3/4 in NPTF(F) or 3/4 in BSPT
Outlet	1/2 in or 3/4 in NPTF(F) or 3/4 in BSPT
Mounting holes	12.7 mm (0.50 in), 4 holes
Mounting hole spacing	153 x 254 mm (6 x 10 in)

Part Number	Description	Weight	Maximum Temperature Rating	Pressure Rating (kPa, PSI, bar)	Hose Type	Hose ID	Hose OD	Hose Length
191-2278	Reel - Hose	40 kg (88 lb)	99 ° C (210 ° F)	27579 kPa, (4000 psi), 275 bar	PVC hose	9.525 mm (0.375 in)	16.3 mm (0.640 in)	23 m (75 ft)
191-2282	Reel - Hose	46 kg (101 lb)	99 ° C (210 ° F)	10342 kPa, (2325 psi), 103 bar	SAE 100 R1T hose (1 wire braid hose)	12.7 mm (0.50 in)	20.701 mm (0.815 in)	23 m (75 ft)
191-2283	Reel - Hose	43 kg (95 lb)	65 ° C (150 ° F)	2068 kPa, (9300 psi), 21 bar	SAE 100 R2T hose (2 wire braid hose)	12.7 mm (0.50 in)	21.463 mm (0.845 in)	23 m (75 ft)



WARNING

These hose reels should only be used for their intended compressed air or fluid applications. Not following this warning could be dangerous. - DO NOT convert compressed air hoses for use with oxygen. A hose contaminated with an oil coating could react explosively when oxygen is used, resulting in personal injury or death.

Heavy-Duty High Capacity Hose Reels

Warranty: Six Months



- Twin pedestal reels for high volume air-water requirements
- Ideal for portable service trucks as well as permanent service or plant work areas
- Maximum temperature: 98.9° C (210° F)
- Reel inlet: 1 inch NPTF(f)

Dimensions

Dimensions

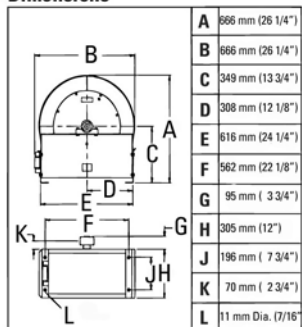

Four 11 mm (7/16 in) Diameter Mounting Holes

Part Number	Description	Weight	Working Pressure	Hose Assembly Capacity		
				Inner Diameter	Outer Diameter	Length
191-2283	Reel - Hose	43 kg (95 lb)	2068 kPa, (9300 psi), 21 bar	12.7 mm (0.5 in)	21.463 mm (0.845 in)	23 m (75 ft)

Medium Pressure Hose Reel — Air, Water, and Oil

- Furnished standard with S.A.E. 100 R1 T one wire braid hose suitable for air, water, or oil applications
- Maximum temperature: 98.9° C (210° F)
- Reel inlet: 1 inch NPTF(f)

Part Number	Description	Weight	Working Pressure	Hose Assembly Capacity		
				Inner Diameter	Outer Diameter	Length
191-2282	Reel - Hose	46 kg (101 lb)	10342 kPa, (2325 psi), 103 bar	12.5 mm (0.5 in)	20.701 mm (0.815 in)	23 m (75 ft)

High Pressure Reel — Grease

- Furnished with SAE 100 R2 T two wire braid hose
- Reel Inlet: 1/2 inch NPTF(f)
- Do not use for anything but grease without factory approval

Part Number	Description	Weight	Working Pressure	Hose Assembly Capacity		
				Inner Diameter	Outer Diameter	Length
191-2278	Reel - Hose	40 kg (88 lb)	27579 kPa, (4000 psi), 275 bar	9.525 mm (0.375 in)	16.3 mm (0.640 in)	23 m (75 ft)

Reelcraft Heavy-Duty Low Pressure Hose Reel

Warranty: Six Months

- All steel construction, heavy-duty reels
- More compact reel for applications with critical space requirements
- Incorporates contemporary engineering and manufacturing techniques to give trouble-free performance at a price competitive with less durable reels
- Maximum temperature: 98.9° C (210° F)
- Reel inlet: 1/2 inch NPTF(f)

1U-7741



Low Pressure Hose Reel — Air and Water

Dimensions

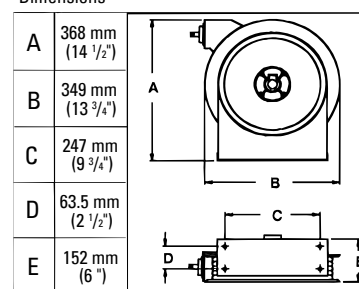

Four 7.9 mm (5/16 in) diameter mounting holes

C58170T1

Part Number	Description	Weight	Working Pressure	Hose Assembly Capacity			Used with
				Inner Diameter	Outer Diameter	Length	
1U-7741	Heavy-Duty Low Pressure Hose Reel	12.7 kg (28 lb)	2068 kPa (300 psi)	9.5 mm (3/8 in)	17.5 mm (0.689 in)	10 m (35 ft)	9U-6286

Hose Reels

Warranty: Six Months

- Hose reels can be used for air tools, fleet maintenance facilities, wash-down bays, service trucks, utility trucks, agricultural, industrial, mining, and many other applications
- Used with 231-0039 Hose

231-0041 Heavy-Duty Plastic Hose Reel

- Locks in place with seven-position locking bracket or freely swivels up to 180 degrees
- Adjustable hose stop sets length of hose remaining outside of hose reel when fully retracted
- Can be wall- or ceiling-mounted
- Built-in handle for carrying ease
- Free standing, flat base allows reel to sit on ground
- Maximum working pressure: 2400 kPa (350 psi)
- Reel comes with 15 meters (50 ft) of 9.6 mm (0.38 in) ID hose



(Continued)

231-0041 Heavy-Duty Plastic Hose Reel (Continued)

- 2 rewind options (hose latches every 0.91 m [3 ft] for extended use or free run for immediate, automatic rewind)
- Made from tough, heavy-duty plastic

Part Number	Description	Used with
231-0041	Heavy-Duty Hose Reel	231-0039

231-0042 Steel Hose Reel



- Easily mounts to wall, workbench, or vehicle
- Heavy-duty, steel drum construction with black baked enamel finish
- Designed with bend restrictor, brake, and inlet swivel
- Tapered side walls and swivel handle makes rewinding hose quick and easy
- Reel comes with 15 m (50 ft) of 9.6 mm (0.38 in) ID hose — total capacity of 30 m (100 ft)
- Maximum working pressure: 2400 kPa (350 psi)

Part Number	Description
231-0042	Steel Hose Reel