



# CAT<sup>®</sup> UNDERCARRIAGE

LOWER COST. LONGER LIFE.

CATERPILLAR OEM SOLUTIONS



# NEARLY 120 YEARS OF UNDERCARRIAGE EXPERIENCE

**To keep your business on firm footing, you need undercarriage systems and components that propel your machines over any type of terrain — and through every operational challenge.**

Caterpillar designs, engineers, tests, and manufactures undercarriage systems and components — delivering the quality you expect.

With decades of experience in logging/forestry, mining, agriculture, material handling, and other challenging industries — we build undercarriage components to work within integrated systems, provide exceptional reliability and durability, and wear at a balanced rate.

## **CUSTOMIZATION FOR YOUR APPLICATION:**

- » Gear ratio and power options for various applications
- » General Duty, Heavy Duty, HDXL options
- » Rubber and steel tracks
- » Various shoe types and widths
- » Customizable paint colors



## **3 FACTORS TO CONSIDER:**

Caterpillar engineers have developed computerized analysis systems to determine the correct undercarriage for your application. This helps yield low operating costs, long service life, and great value.

**The components you choose will depend on three main factors:**

- Machine weight
- Machine application
- Desired undercarriage life

We can help you choose the right undercarriage for you application.

# CAT® UNDERCARRIAGE

## LOWER COST. LONGER LIFE.

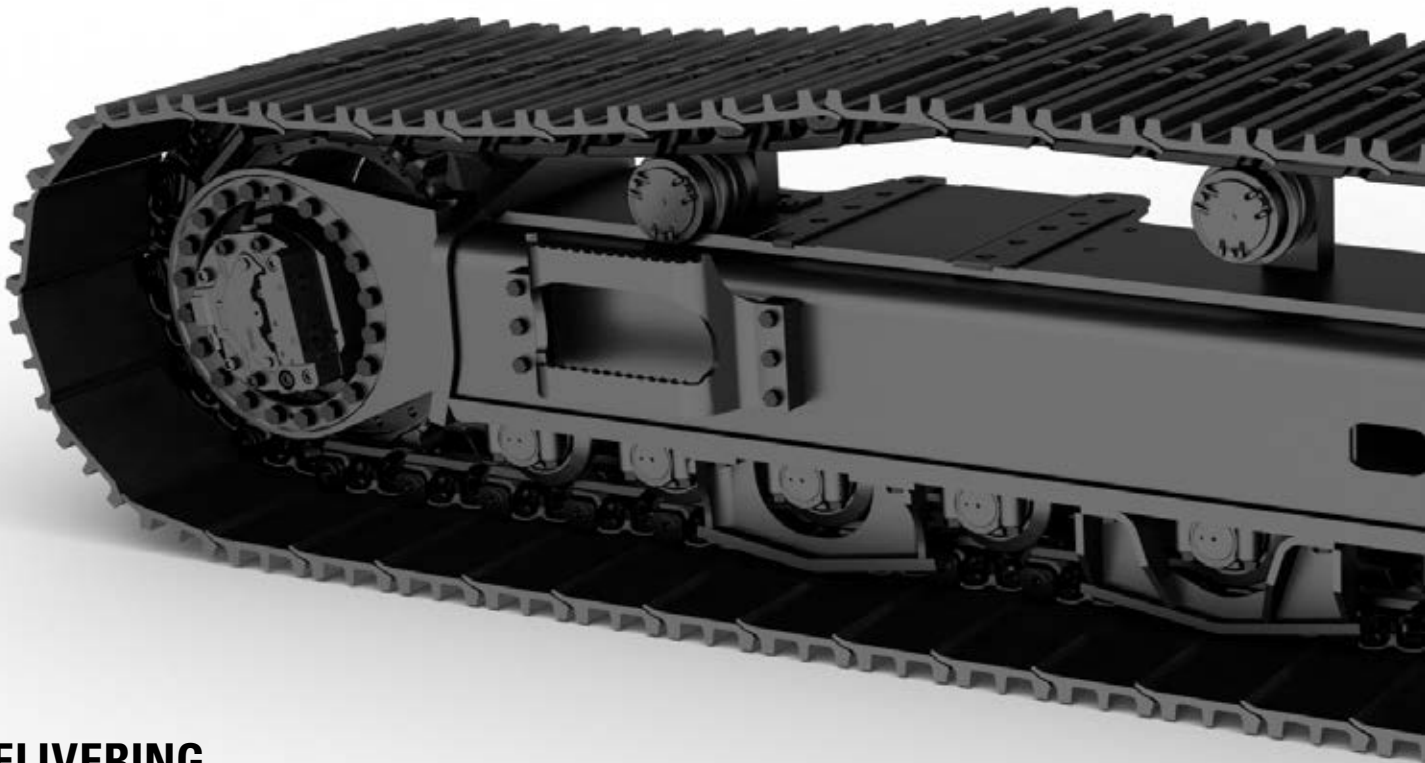

### **DELIVERING PROVEN PERFORMANCE**

- » Cat® undercarriage is factory and field tested.
- » Tests have shown that Cat undercarriage delivers up to 2 times the life of competitive undercarriage.
- » With longer wear life and lower cost per hour than competitive brands, Cat undercarriage delivers the best return on your investment.

### **DESIGNED FOR SPECIFIC APPLICATIONS**

- » Caterpillar engineers understand how demanding applications wear undercarriage components – so they design them as a system.
- » Each undercarriage is built to take on specific conditions such as sand, gravel, mud, and clay.

**Available Pitch Sizes: 101.6 mm – 260.4 mm**

General Duty Track | Heavy Duty Track | Heavy Duty XL Track



## **OUTLASTS THE COMPETITION**

- » Because Caterpillar manufactures its own undercarriage, every component meets strict specifications and quality standards that no competitor can match.
- » Durable, reliable components result in lower operating costs.

# OUTLASTS THE COMPETITION

## TRACK SHOES

Rolled from modified medium carbon steel and deep-hardened for long wear life. Heavy cross-sections with curved leading and trailing edges resist bending. Available in a wide range of styles and widths.

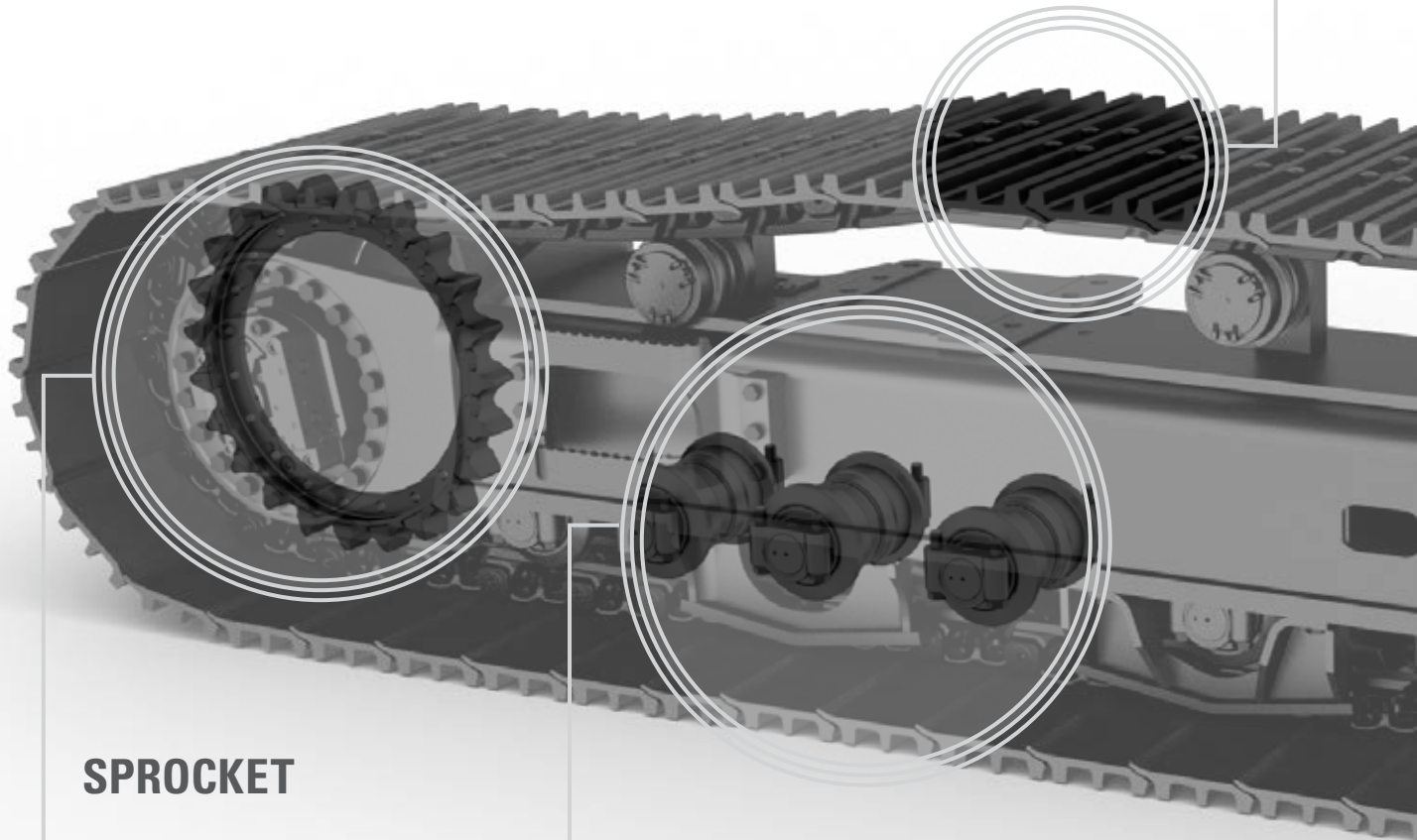

## SPROCKET

Superior surface hardness, hardened depth, and core hardness provide long wear life, resistance to bending / breakage and maximum hardware retention. Available in three styles.

## TRACK ROLLERS

Hardened for long wear life, unmatched structural support and resistance to deformation. Sealed and Lifetime Lubricated with Cat Duo-Cone Seals.

Track rollers are available with single or double flange. Wide flanges resist rollover. High-strength steel and deep hardening virtually eliminate wear, shock loads and bell mouting. Sleeve bearings and large, hardened shafts absorb impacts and deflection.

## CARRIER ROLLERS

Hardened for long wear life, unmatched structural support and resistance to deformation. Sealed and Lifetime Lubricated with Cat Duo-Cone® Seals.

Carrier Rollers incorporate large shafts and bearings to promote longer component life. Cantilever-mounted to minimize material build-up and provide easier cleaning. Hardened rims resist cracking and chipping.

## IDLER

Cast or fabricated with internal reinforcing plates for superior strength and durability. Sealed and Lifetime Lubricated with Cat Duo-Cone Seals.

## GUARDS

Track guiding guards help align the equipment tracks during operation.

## LINKS

Manufactured for excellent wear resistance, strength and durability. Special heat-treatment processes produce consistent surface hardness, superior hardened depth and strong core hardness.

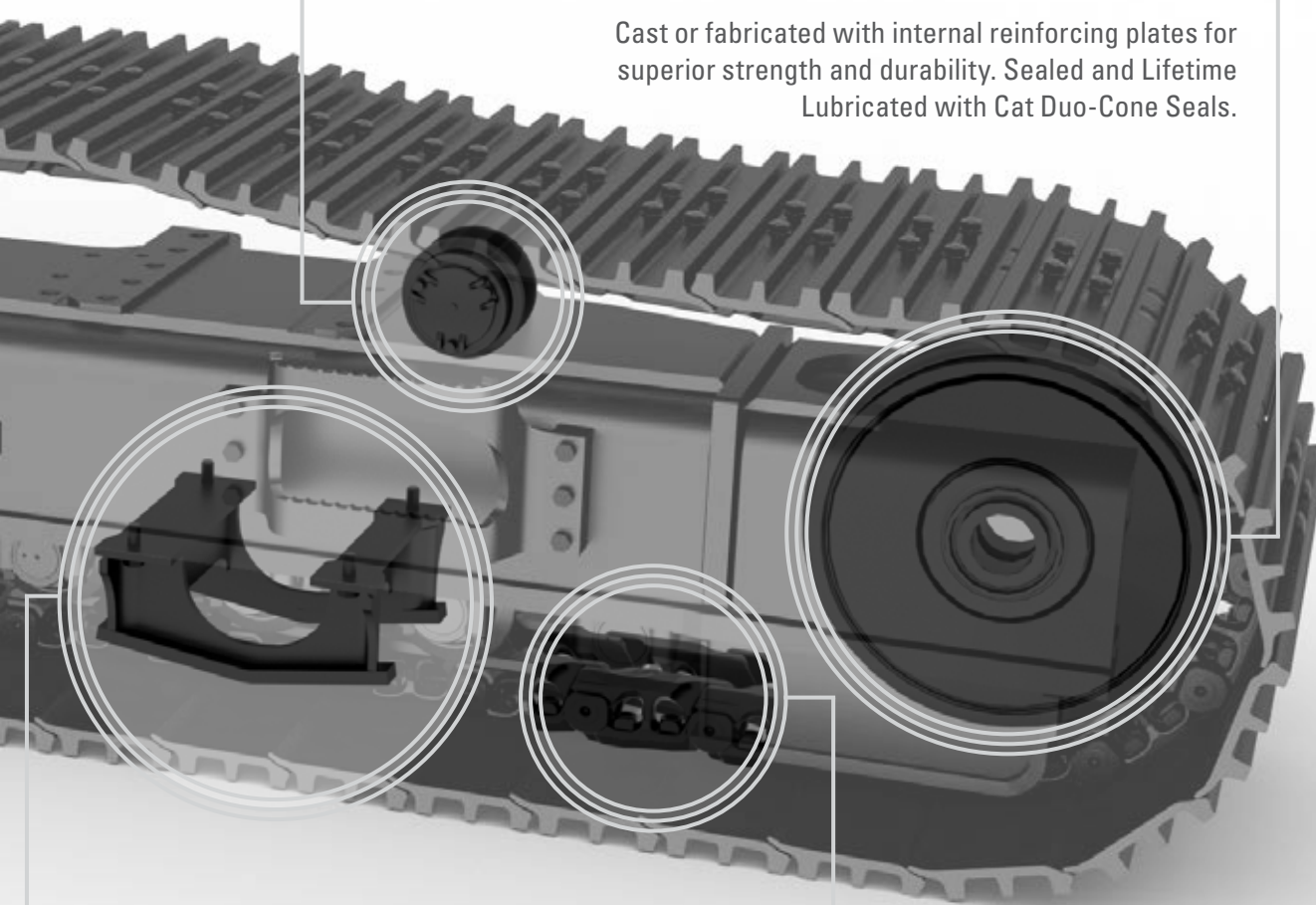

# TRACK SHOE SELECTION

**Single Grouser (SG) Shoes** provide good penetration and traction.

**Double Grouser (DG) Shoes** offer less turning resistance for greater maneuverability.

**Triple Grouser (TG) Shoes** offer the lowest penetration and resistance and best maneuverability.

**Special Use Shoes**, such as flat, self-cleaning and rubber/polyethylene-bonded, are available in some sizes.

**Extreme Service Shoes** provide longer wear in high-impact and abrasive conditions.

**Shoes with special features**, such as clipped grousers or mud slots, are also available.

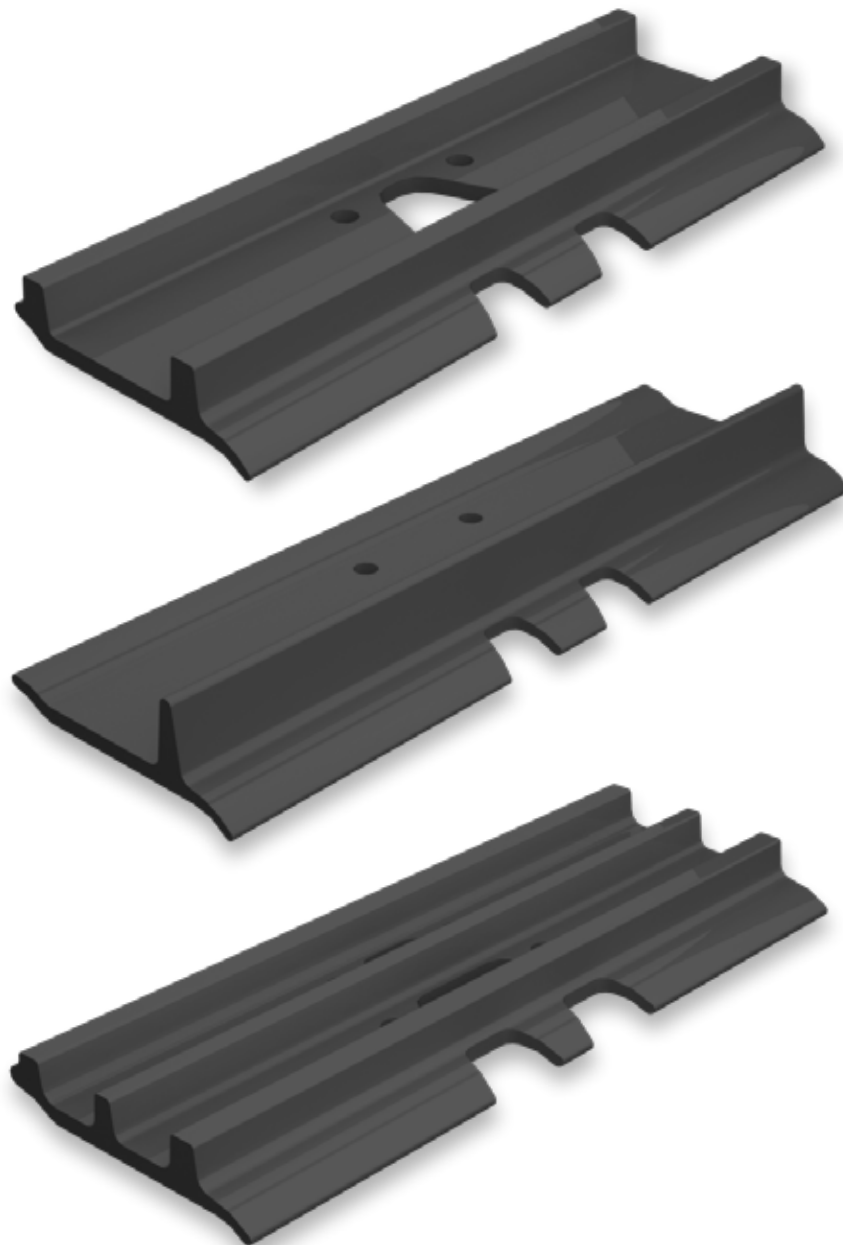



# CAT UNDERCARRIAGE OPTIONS

MODEL	TRACK PITCH	GENERAL DUTY	HEAVY DUTY	HEAVY DUTY XL
304	101.6 mm	•	•	
305	135 mm	•	•	
306	135 mm	•	•	
308	154 mm	•	•	
312-316	171.5 mm	•		
320	190.5 mm	•	•	•
330	203.2 - 215.9 mm	•	•	•
336, 340	215.9 mm	•	•	
349, 352	215.9 mm	•	•	•
374, 395	260.4 mm	•	•	

low-to-moderate impact applications

medium impact and medium travel in tough underfoot conditions

high-impact and high-travel applications



# CATERPILLAR SERVICE AND SUPPORT

We welcome the opportunity to learn more about your company's unique needs—and to show you how turning to Caterpillar for custom or standard undercarriage systems can lead to comprehensive solutions that help build your business.

**For more information on Cat Undercarriage, contact OEM Solutions:**

[oem\\_solutions@cat.com](mailto:oem_solutions@cat.com) | [www.cat.com/oemsolutions](http://www.cat.com/oemsolutions)

PEDJ1209 (02-2023)  
(Global)

© 2023 Caterpillar  
All rights reserved

Materials and specifications are subject to change without notice.

CAT, CATERPILLAR, LET'S DO THE WORK, their respective logos, "Caterpillar Corporate Yellow," the "Power Edge" and Cat "Modern Hex" trade dress as well as corporate and product identity used herein, are trademarks of Caterpillar and may not be used without permission.

